

FLEET SPECIFICATIONS
Bavaria Cruiser 41 - Giuli



Year: 2014

Length (m): 12,35

Max Beam (m): 3,96

Draft (m): 2

Cabins: 3

WC: 2

Berths: 6+2

Main Sail: Furling

Genoa: Furling

Bimini Top: Yes

Sprayhood: Yes

Teak: Cockpit

Engine: 55hp Volvo

Fuel (lt): 200

Water (lt): 260

Hot Water: Yes

Fridge - Freezer: Yes

Electric Windlass: Yes

Log - Echo: Yes

GPS Plotter: Yes

Autopilot: Yes

Wind Station: Yes

V.H.F.: Yes

Battery Charger: Yes

Electric Supply: 220 - 12 Volt

Radio - CD: Yes

Dinghy: Yes

Bow thruster: Yes

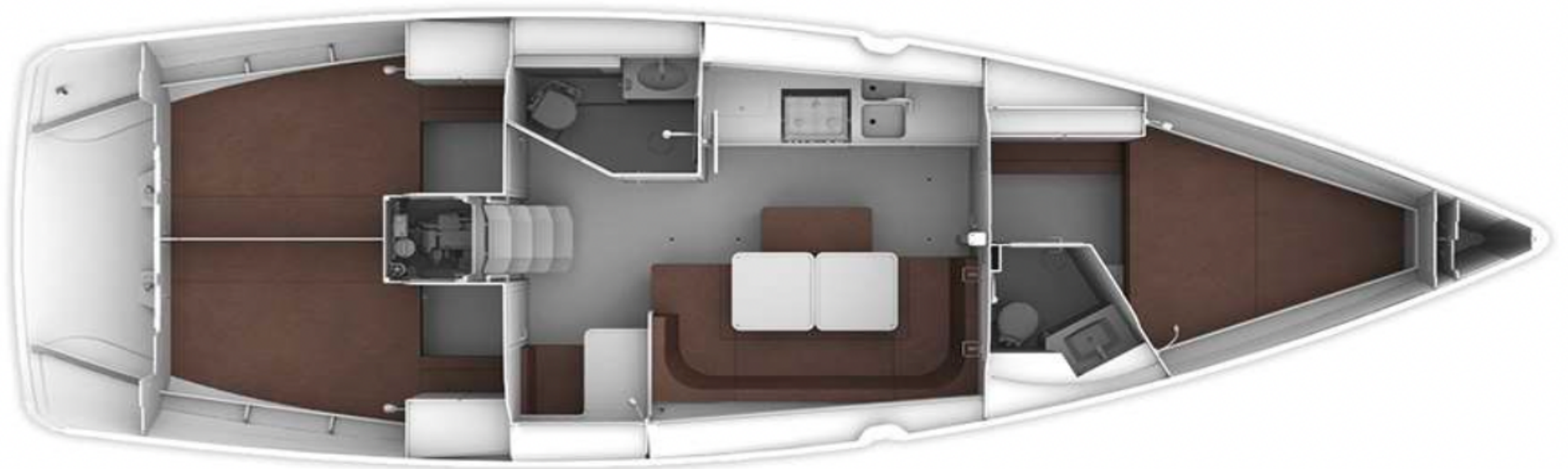



FLEET SPECIFICATIONS
More 40 - Black Widow

